

Dealers Invitation to Bid

9/8/2017

ORIGINAL

Class: P/U - 4x4

Body Code: F3

3/4 T 4X4 TRUCK

Representative Models: 1: FORD
3: RAM

F250 PU
2500 PU

2: CHEVROLET 2500 PU
4: NISSAN TITAN XD

MAKE: CHEVY MODEL: SILVERADO OEM MODEL #: CK25903 TRIM LEVEL: WT OEM CODE: _____

STANDARD SPECIFICATIONS:

OEM CODE INDICATE ACTUAL DEALER SPECIFICATIONS

101	PASS: 3 PERSONS MIN.	STANDARD
110	DOORS: 2 SIDE DOORS	STANDARD
121	LONG BED	STANDARD
140	TIRES: ALL SEAS M&S RADIAL	STANDARD
146	FULL SIZE SPARE TIRE	STANDARD
183	WHEELBASE: 131.0 IN. MIN	133.6
197	ENG MIN CYL: 8	STANDARD
236	GVW RATING: 8500 MIN	9500
298	CRUISE CONTROL/TILT	STANDARD
300	AIR CONDITIONING - R134a	STANDARD
302	RADIO: AM/FM	STANDARD
307	POWER BRAKES & POWER STEERING	STANDARD
308	ABS BRAKES	STANDARD
310	SEATS: CLOTH SEATS	STANDARD
321	FLOORING: RUBBER	STANDARD
340	AIR BAG - DRIVER SIDE	STANDARD
350	STD ENG: SPECIFY	L96 6.0 V8
400	MIRRORS: RIGHT AND LEFT	STANDARD
404	INTERMITTENT WIPERS	STANDARD
410	TRANSMISSION: AUTOMATIC	STANDARD
415	FOUR-WHEEL DRIVE	STANDARD
418	AUTOMATIC LOCKING FRONT HUBS	STANDARD
459	STEP BMPR-500#TONGUE,5000#TLR	STANDARD
752	AXLE RATIO: SPECIFY	GT5 4.10
883	BACKUP CAMERA	STANDARD
910	PRIMARY FUEL: UNLEADED	STANDARD
991	STD WRNTY - BUMPER TO BUMPER 3/36	STANDARD

STANDARD VEHICLE BASE PRICE \$ 24,924

AVAILABLE OPTIONS:

OEM CODE ACTUAL / COMMENTS

PRICE

097 CREW CAB (4 DOORS): SPECIFY CA

CK25943 55.6" \$ 3122

CK25743 41.26" \$ 2922

Colorado State Fleet Management
2018 VEHICLE SPECIFICATIONS

Dealers Invitation to Bid

9/8/2017

Class: PU - 4x4

Body Code: F3

3/4 T 4X4 TRUCK

Representative Models: 1: FORD
3: RAM

F250 PU
2500 PU

2: CHEVROLET 2500 PU
4: NISSAN TITAN XD

MAKE: CHEVY MODEL: SILVERADO OEM MODEL #: CK25903 TRIM LEVEL: WT OEM CODE: _____

AVAILABLE OPTIONS:	OEM CODEACTUAL / COMMENTS	PRICE
098 EXT CAB LONG BED 3 OR 4 DOOR	CK25953	861
099 EXT CAB SHORT BED 3 OR 4 DOOR	CK25753 6 1/2' BED 41" CA	861
122 SHORT BED	NOT AVAILABLE	
133 BACK UP ALARM	8S3	138
141 TIRES: ALL-TERRAIN, LIST SIZE:	QXT 265/70R17E	200
143 TIRES: OPTION #1, LIST SIZE:	QGM 265/70R18E REQUIRES 18" WHEEL \$295	200
152 SPILT BENCH 40/20/40 FULL CONSOLE	AZ3 REQUIRES 599	435
216 NON-STD ENGINE OPTION A:	NOT AVAILABLE	
217 ENG OPTION: DIESEL	L5P DURAMAX	7889
218 NON-STD ENGINE OPTION B:	NOT AVAILABLE	
229 HEAVY DUTY SUSPENSION SPECIFY TYPE:	STANDARD	
239 GVW OPTION: SPECIFY	C4M 9900# REQUIRES 217	
244 AXLE RATIO (MIN.) 4.10	STANDARD	
249 AXLE RATIO OPTION: SPECIFY	GT4 3.73	100
252 CNG PREP PACKAGE	LC8	400
254 ALT FUEL - OEM BI FUEL SPECIFY TANK LOC	POWER SOLUTIONS OEM SEE NOTES PAGE 4	11330
255 ALT FUEL - OEM DEDICATED SPEC TANK LOC	POWER SOLUTIONS OEM SEE NOTES PAGE 4	10860
256 E85 - OEM BI FUEL	STANDARD	
262 DARKEST LEGAL TINT AVAIL	AKO ON BASE ONLY CALL FOR OTHERS	100
268 CUSTOM CLOTH SEAT W/CNTR CNSOLE STRG	AZ3 REQUIRES 599	435
284 REMOTE KEYLESS ENTRY	PCR	725
311 SEATS: VINYL SEATS	HTQ	NO CHARGE
312 SEATS: BUCKET SEATS - CLOTH	NOT AVAILABLE	
401 MRRS:REC/CMPR FOR TWNG (7"x9")	DPN POWER REQUIRES 284 \$350 DF2 70	
408 REAR AXLE - ANTI SPIN	STANDARD	
411 TRANSMISSION: MANUAL W/OVERDRV	NOT AVAILABLE	
423 TOOL BOX - ACROSS BED BOX(attachment)		366
424 TOOL BOX - SIDE BED BOX(attachment)		348
429 TRAILER BRAKE CONTROL-ELECTRIC	JL1	275
430 PCKG:TOWING/RCVR HITCH(Atchml)		300
432 TOW HOOKS	STANDARD	
436 HEAVY DUTY COOLING	STANDARD	
438 PACKAGE:SNOW PLOW (atichml)		3667
439 OEM SNOW PLOW PREP	VYU	385
440 PACKAGE:OFF ROAD (Attachment)		350

Colorado State Fleet Management
2018 VEHICLE SPECIFICATIONS

Dealers Invitation to Bid

9/8/2017

Class: P/U - 4x4

Body Code: F3

3/4 T 4X4 TRUCK

Representative Models: 1: FORD
3: RAM

F250 PU
2500 PU

2: CHEVROLET 2500 PU
4: NISSAN TITAN XD

MAKE: CHEVY MODEL: SILVERADO OEM MODEL #: CK25903 TRIM LEVEL: WT OEM CODE: _____

AVAILABLE OPTIONS:	OEM CODE	ACTUAL / COMMENTS	PRICE
443 PKG: STROBE LIGHT (Attachment)			280
444 ENGINE BLOCK HEATER	K05		100
450 SKID PLATE-FUEL TNK,TRFR CS/DI	NZZ		100
454 AUXILARY BATTERY	K4B	NOT AVAILABLE 217 AND 254	135
462 GOOSENECK HITCH (attchmnt)			881
468 SPRAY IN BEDLINER			450
472 EPACT AFV CREDIT: Specify		NOT AVAILABLE	
516 LEFT DOOR POST SPOTLIGHT (50W)			450
520 POWER LOCKS		STANDARD	
521 HEAVY DUTY ALTERNATOR	KW5		150
526 POWER MIRRORS	PCR	INCLUDES 530	725
530 POWER WINDOWS	PCR	INCLUDES 526	725
541 DELETE DAYTIME/AUTO HEADLIGHTS		DEALER	240
599 AM/FM CD PLAYER		NO CD AVAILABLE	
608 HYBRID GAS/ELECTRIC		NOT AVAILABLE	
620 UPPER TRIM LEVEL PKG: SPECIFY	LT		4635
643 ADD DAYTIME RUNNING LIGHTS		STANDARD	
658 EXTRA KEYS & REMOTES		REMOTE 80 KEY	41
683 MEETS 2010 FED EMISSIONS DIESEL ENG		INCLUDED	
694 DIESEL ENG B20 COMPLIANT		REQUIRES 217	
763 PHEV (PLUG IN HYBRID ELEC VEH)		STANDARD	
780 UPFITTER SWITCHES	9L7		125
791 TOPPER FIBERGLASS 3 WINDOW (Attachment)			1567
841 ALT FUEL/GAS SWITCH		INCLUDED WITH 254	
845 BLIND SPOT NOTIFICATION	Y65	REQUIRES 620	1775
887 BEV (BATTER/ELECTRIC)		NOT AVAILABLE	
982 EXT WARRANTY - POWER TRAIN 5/100,000		STANDARD INCLUDED NO CHARGE	

Colorado State Fleet Management
2018 VEHICLE SPECIFICATIONS
Dealers Invitation to Bid

9/8/2017

Class: P/U - 4x4

Body Code: F3

3/4 T 4X4 TRUCK

Representative Models: 1: FORD
3: RAM

F250 PU
2500 PU

2: CHEVROLET 2500 PU
4: NISSAN TITAN XD

MAKE: CHEVY MODEL: SILVERADO OEM MODEL #: CK25903 TRIM LEVEL: WT OEM CODE: _____

AVAILABLE COLORS: Please attach manufacturer color chart

OTHER VEHICLE SPECIFICATIONS / OPTIONS (Please attach separate sheet if necessary)	PRICE
<u>254 TANK BEHIND CAB</u>	_____
<u>255 TANK BEHIND CAB</u>	_____

STANDARD FACTORY WARRANTY (Attach detailed description):

	MILES	MONTHS
Bumper to Bumper	<u>36K</u>	<u>36</u>
Drive Train	<u>100K</u>	<u>60</u>
Other	_____	_____

OPTIONAL FACTORY WARRANTY (Attach detailed description):

	MILES	MONTHS	PRICE
<u>SEVERAL AVAILABLE CALL FOR DETAILS</u>	_____	_____	_____

EPA FUEL RATING: N/A M.P.G CITY, N/A M.P.G HIGHWAY

OEM MINIMUM FUEL RATED OCTANE: 85

DELIVERY: APPROX 60 DAYS FROM DEALER RECEIPT OF ORDER FROM STATE (E.G. 90 DAYS)

IDENTIFY ANY EXCEPTIONS TO SPECIFICATIONS:

DEALER NAME: JOHN ELWAY CHEVROLET

BIDDER'S NAME: MARK MCMUNN

DEALER PHONE: 720.284.5255

SIGNATURE: 

PROpane

Vehicle Description	Engine	Tank Location	Code	GVW
3500HD Truck 2WD & 4WD	6.0L	Back of Cab	36	10,001-14,000
G3500 Express Cutaway	6.0L	Alt Axle & Midship	62	10,001-14,000
G4500 Express Cutaway	5.0L	Alt Axle & Midship	62	14,000 - 33,000
2500HD Truck 2WD & 4WD	6.0L	Back of Cab	36	8501-10,000
3500 Low Cab Forward	6.0L	Multiple Configurations Available		
4500 Low Cab Forward	6.0L	Multiple Configurations Available		

NATURAL GAS

Vehicle Description	Engine	Tank Location	Code	GVW
G2500 Passenger Van	5.0L	Alt Axle & Midship	16	8501-10,000
G3500 Passenger Van	6.0L	Alt Axle & Midship	16	10,001-14,000
3500HD Truck 2WD & 4WD	6.0L	Back of Cab	21	10,001-14,000
G3500 Express Cutaway	6.0L	Alt Axle & Midship	16	10,001-14,000
G4500 Express Cutaway	5.0L	Alt Axle & Midship	16	14,000 - 33,000
3500 Cab Chassis 2WD & 4WD	6.0L	Back of Cab	21	10,001-14,000
2500HD Truck 2WD & 4WD	6.0L	Back of Cab	21	8501-10,000
G2500 Cargo Van	6.0L	Alt Axle & Midship	16	8501-10,000
G3500 Cargo Van	6.0L	Alt Axle & Midship	15	8501-10,000
3500 Low Cab Forward	6.0L	Multiple Configurations Available		
4500 Low Cab Forward	6.0L	Multiple Configurations Available		



POWER SOLUTIONS
INTERNATIONAL

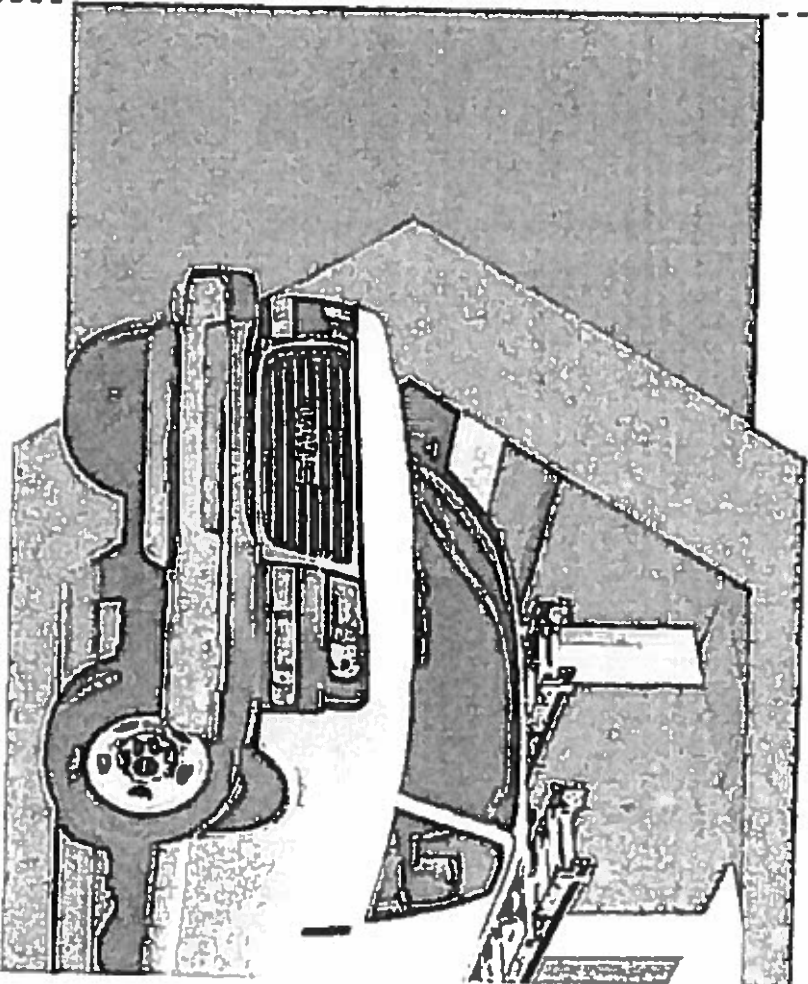

PSI-GM SPECIALTY VEHICLE
MODIFIER (SVM)



POWER SOLUTIONS
INTERNATIONAL

201 Mikkel Drive, Wood Dale, IL 60191
630.350.9400 | www.psiengines.com

CURRENT GM APPLICATIONS



SILVERADO & SIERRA
2500/3500 HD PICKUPS



EXPRESS & SAVANA
2500/3500 VANS
3500/4500 CUTAWAYS



LOW CAB FORWARD
3500/4500 HD TRUCKS

HOW IT WORKS

- PSI performs alternative fuel conversions including natural gas and propane on a range of GM vehicles.
- GM customers can seamlessly order and take delivery from any GM dealerships.
- GM will supply vehicles equipped with specialized version 6.0L V-8 engine to PSI, which in turn will provide the fuel system and integration hardware.
- All PSI Alternative fuel conversions are covered by PSI's 3-year/36,000-mile warranty in addition to Chevrolet and GMC's five-year/60,000-mile limited powertrain warranty and a considerable value that no other aftermarket provider can offer.

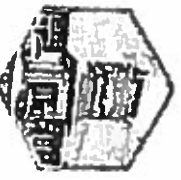

GM DEALERS



FLEETS



BODY BUILDERS



OEMS

A NEW GENERATION FOR PROPANE

Bi-Phase Gen II maintains the heat resisting benefits of coaxial fuel lines up near the engine where it is hottest, while utilizing simpler and more common materials and components in the vehicle length fuel lines and in the LP tank.

Bi-PhaseGen II has the unique and effective Bi Phase Liquid LP injector and fuel trails.

- MORE ECONOMICAL
- SIMPLIFIED INTEGRATION
- HIGHER RELIABILITY

PROPANE

1. Fuel Distribution Block Configurable for Many Engines
2. Pressure Test Port Easy Accessible for Tech
3. Coaxial Fuel Pipe Supplies Fuel to Injectors & Returns Fuel to Tank
4. Supply and Return Ports Easily Accessible for Assembly Line
5. Fuel Pressure/Temp Sensor Engine Mounted for Direct Accuracy
6. Fuel Rail Assembly Easily Available for Many Engines

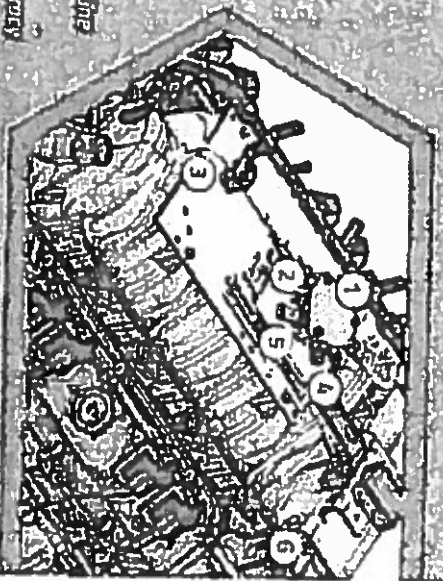

NATURAL GAS

1. Fuel Pressure Regulator G Bon Set Point
2. Fuel Rail Assembly Configurable for Many Engines
3. Bosch Witztec GNG Injector Excellent Fuel Metering Control

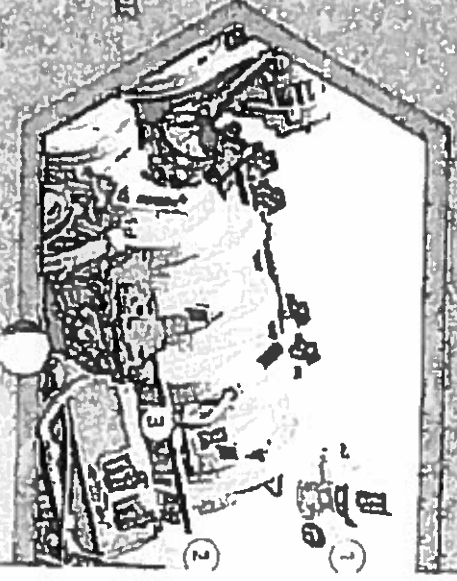

**Colorado State Purchasing Office (per SFM)
LIST AND EXPLANATIONS OF VEHICLE PACKAGES
FOR THE 2018 MODEL YEAR FLEET VEHICLE PROPOSALS**

Page 2 of 52

#423 - PACKAGE: TOOLBOX - ACROSS BED BOX

Attach one copy of this form to each body code specification sheet that has an Available Option #423 including the following body codes:

E1, E2, E3, E4, E8, F1, F2, F3, F4, F8

An installed **TOOLBOX - ACROSS BED BOX PACKAGE** should include the following:

- Delta brand or equivalent
- Either a gull-wing, double lid or chest-style, full-hinged, single lid crossover toolbox
- Painted white with all steel construction
- Torsion bar lift on lid(s)
- Removable tray
- Weather stripping around lid(s)
- A lock on each lid with key
- Price to include complete installation.

Total Price for TOOL BOX - ACROSS BED BOX PACKAGE:

- A gull-wing, double lid, tool box:

\$

- a chest-style, full-hinged, single lid crossover toolbox:

\$

For Body
Code:

**Colorado State Purchasing Office (per SFM)
LIST AND EXPLANATIONS OF VEHICLE PACKAGES
FOR THE 2018 MODEL YEAR FLEET VEHICLE PROPOSALS**

Page 3 of 52

#424 - PACKAGE: TOOL BOX - SIDE BED

Attach one copy of this form to each body code specification sheet that has an Available Option #424 including the following body codes:

E1, E2, E3, E4, E8, F1, F2, F3, F4, F8

An installed **TOOLBOX - SIDE BED (Rail Mount) PACKAGE** should include the following:

- Delta Brand Rail Mount Box or equivalent
- A quantity of one, side-bed, rail mount, utility, tool box
- Toolbox must sit on top of the truck bed side rail
- Painted white with all steel construction
- A lock on the lid with key
- Removable tray
- Weather stripping around lid
- Price to include complete installation, rearward of an optional across bed box.

Total Price for 48" TOOLBOX - SIDE BED PACKAGE:

\$

Total Price for 60" TOOLBOX - SIDE BED PACKAGE:

\$

For Body Code:

**Colorado State Purchasing Office (per SFM)
LIST AND EXPLANATIONS OF VEHICLE PACKAGES
FOR THE 2018 MODEL YEAR FLEET VEHICLE PROPOSALS**

Page 4 of 52

#430 - PACKAGE: OEM TOWING OPTION

Attach one copy of this form to each body code specification sheet that has an Available Option #430 including the following body codes:

C2, C3, C4, D1, D2, D3, D5, D8, E2, E3, E4, E8, F2, F3, F4, F8, K1, K2, K3, K5, K6, T1, T4, T5

An installed **OEM TOWING OPTION PACKAGE** should include the following:

- Frame mounted receiver hitch with a class 3 (class 4 for T1, T4, T5) rating that accepts a 2" square receiver
- Heavy duty engine cooling
- Transmission cooling (automatic only)
- Trailer wiring harness
- HD turn signal flasher
- Handling package (describe: _____)
- _____
- HD battery and Alternator.
- Price to include complete installation.
- All items to be covered at a minimum by the 3 year 36,000 mile factory warranty

Please list additions and/or deletions to your company's OEM TOWING OPTION package from the above listed specs:

Z82

Total Price for OEM TOWING PACKAGE: \$

For Body Code:

Total Price for T1 - OEM TOWING PACKAGE: \$

**Colorado State Purchasing Office (per SFM)
LIST AND EXPLANATIONS OF VEHICLE PACKAGES
FOR THE 2018 MODEL YEAR FLEET VEHICLE PROPOSALS**

Page 5 of 52

#438 - PACKAGE: SNOW PLOW

Attach one copy of this form to each body code specification sheet that has an Available Option #438 including the following body codes:

F3, F4, F8, H3, T1, T4, T5

An installed **SNOW PLOW PACKAGE** should include the following:

- Meyer Standard Series Snowplow model #ST 7.5 or equivalent (7 1/2 foot blade).
- To be installed on a full size, 4WD pickup (Ford, Chevy or Dodge) with a minimum GVW rating of 8500 lbs
- The plow mounting kit used must be specifically designed for use on this vehicle.
- Must have dual batteries with isolator as a power source for the plow.
- Either an all-steel moldboard or a polymer moldboard with a high carbon steel cutting edge blade.
- Quick disconnect of front-end hardware, lights, and hydraulic unit.
- Hydraulic powered lift with electric, solenoid operated controls inside the cab that will allow the plow to be angled from side to side and lifted up and down.
- Additional headlights and directional lights above the plow. Must be a vibration free installation connecting to either the bumper or the plow hitch.
- Price to include complete installation.
- Audible back up alarm (light bulb type acceptable)
- Includes standard factory warranty of at least one year parts/labor

Specify how normal use of snow plow will not cause vehicle air bag to be engaged:

Please list additions and/or deletions to your company's **SNOW PLOW PACKAGE** from the above listed specs:

Total Price for SNOW PLOW package with all steel moldboard:

\$

3667

Total Price for SNOW PLOW package with polymer moldboard:

\$

4420

For Body Code:

F3

**Colorado State Purchasing Office (per SFM)
LIST AND EXPLANATIONS OF VEHICLE PACKAGES
FOR THE 2018 MODEL YEAR FLEET VEHICLE PROPOSALS**

Page 6 of 52

#440 - PACKAGE: OEM OFF ROAD

Attach one copy of this form to each body code specification sheet that has an Available Option #440 including the following body code:

F1, F2, F3, F4, F8, K1, K2, K3, K5, K6, T1, T4, T5

An installed **OEM OFF ROAD** package should include the following:

- High pressure front and rear gas shocks
- H/D springs
- Mud and snow radial tires "LT" rated. Specify tire size:
265/70R/17E ALL TERRAIN
- Skid plate group. Specify types: NZZ
- Front and rear tow hooks
- Limited Slip Rear Axle – Specify Ratio G80 4.10
- All items to be covered at a minimum by the 3 year 36,000 mile factory warranty

Please list additions and/or deletions to your company's OEM OFF ROAD PACKAGE from the above listed specs:

9G3 OFF ROAD SUSPENSION (OPTIONAL SUSPENSION \$275)

Total Price for the OEM OFF ROAD package:

\$ 350

For Body Code:

F3

**Colorado State Purchasing Office (per SFM)
LIST AND EXPLANATIONS OF VEHICLE PACKAGES
FOR THE 2018 MODEL YEAR FLEET VEHICLE PROPOSALS**

Page 7 of 52

#443 - STROBE LIGHT

Attach one copy of this form to each body code specification sheet that has an Available Option #443 including the following body codes:

All C's, D's, E's, F's, G's, H's & K's, P4, PE

The **STROBE LIGHT PACKAGE** must include the following:

- Roof mount of strobe on truck, van or sport utility vehicle
- Dual flash strobe with amber shield
- Class 2 light, SAE spec: J1318 or DFS750-A North American Signal spec or equivalent.
- Minimum: 15 joules
- Minimum of 60 double flashes per minute
- **Base must be aluminum, not plastic.**
- Switch in cab
- Height: between 3 1/2 inches to 6 inches, measured to top of light housing
- Warranty: 1-year parts and labor
- Complete installation with locations as follows:
- **Location for strobe light on pickups:**
- On the roof of the pickup cab
- The light must be centered between the front of the roof and the rear of the roof.
- The light must be also centered from one side to the other side of the roof.
- **Location for strobe light on vans and sport utilities:**
- On the roof of the van or sport utility
- The light must be centered from one side to the other side of the roof
- The light must also be two feet from the rear of the roof.

List the make and model of strobe that is bid:

Make CODE 3 Model LSS222CA

List any additions and/or deletions of your bid from the **STROBE LIGHT PACKAGE** specs listed above:

Total Price for STROBE LIGHT PACKAGE:

\$

280

**Colorado State Purchasing Office (per SFM)
LIST AND EXPLANATIONS OF VEHICLE PACKAGES
FOR THE 2018 MODEL YEAR FLEET VEHICLE PROPOSALS**

Page 8 of 52

**For Body
Code:**

F3

**Colorado State Purchasing Office (per SFM)
LIST AND EXPLANATIONS OF VEHICLE PACKAGES
FOR THE 2018 MODEL YEAR FLEET VEHICLE PROPOSALS**

Page 9 of 52

#462 – GOOSENECK TRAILER HITCH

Attach one copy of this form to each body code specification sheet that has an Available Option #462 including the following body codes:

E3, E4, E8, F3, F4, F8, T1, T4, T5

The **GOOSENECK TRAILER PACKAGE** must include the following:
ONE 5TH WHEEL HITCH WITH FOLDING BALL (2 5/16") MOUNTED IN BED

- Must be retractable ball mount that allows for a clear and smooth pickup bed when not in use
- Capacity: 5000 lbs maximum vertical load
- 25,000 max gross trailer weight
- Weld two ½" steel cross plates (approx. 38" by 4") under the pickup floor and bolt the 5th wheel hitch to these cross pieces
- Weld two more ½" steel plates (approx. 3" by 10") at right angles under the tow cross plates and bolt these pieces to the frame
- Trailer wiring harness – 7 way
- HD turn signal flasher
- Handling package (describe: _____)
- _____
- HD battery
- Price to include complete installation.
- All items to be covered at a minimum by the 3 year 36,000 mile factory warranty

Please list additions and/or deletions to your company's Gooseneck trailer package from the above listed specs:

Total Price for OEM TOWING PACKAGE: \$

For Body Code:

**Colorado State Purchasing Office (per SFM)
LIST AND EXPLANATIONS OF VEHICLE PACKAGES
FOR THE 2018 MODEL YEAR FLEET VEHICLE PROPOSALS**

Page 18 of 52

#791 – TOPPER FIBERGLASS 3 WINDOW

Attach one copy of this form to each body code specification sheet that has an Available Option #791 including the following body codes:

E1, E2, E3, E4, E8, F1, F2, F3, F4, F8

The **TOPPER FIBERGLASS 3 WINDOW PACKAGE** must include the following:

- Astro CR 1800 Topper or Approved Equals
- Construction shall be cab height, fiberglass topper
- Front shall be solid with full width, non-tinted front glass window
- Sides shall be solid with tinted glass windows on each side, sixty (60) inches to seventy (70) inches length (plus or minus one (1) inch and fourteen (14) inches height (plus or minus one half (1/2 inch). Side windows must be centered from front to back of topper with locks and flip up and stay up with one hand operation
- Rear shall be locking, flip up, full width and full height with tinted glass door in the rear. Door must open, remain up and close with one hand operation, to include gas props.
- Keys shall be the same key which must flip side and rear flip up windows. Two keys shall be provided for each truck topper
- Topper shall include 3rd brake light
- Topper color must match truck color
- Warranty min. 3 years on structure, paint and lock cylinder, 5 years on gas props part and labor

List any additions and/or deletions on your bid from the **HYDRAULIC LIFT GATE PACKAGE** specs listed above:

Total Price for TOPPER
FIBERGLASS W/3 WINDOWS:

1567

For Body
Code:

F3